

3723 Topeka Trail

Heartland, TX 75126

4 

2.0 

2,129 

2 



This grand and timeless concept is perfect for growing families looking for a smaller space without having to sacrifice privacy or openness in the living areas. Step in from the covered front porch and enjoy a foyer with boxed ceilings, welcoming you inside. Set just off the foyer is the study with double doors, a space to work from home, or simply enjoy doing hobbies. The open-concept kitchen, which is centered in the heart of the home, features a large central island, beautiful white cabinets, granite countertops, stainless steel appliances, ample counter and storage space, and a corner walk-in pantry. The kitchen opens to a breakfast nook, complete with a sunny window seat, perfect for additional seating. Enjoy a spacious family room flooded by natural light, welcoming friends and family to gather. The family room provides direct access to the rear covered patio. Designed for rest and relaxation, the master suite is tucked away off the family room. Enjoy a spacious room with boxed ceilings and a large walk-in closet. Accessible by double doors in the adjoining master bathroom featuring a dual sink vanity, large garden tub with ledge, separate walk-in shower with a seat, and a linen closet. Making them perfect for kids or guests, three additional bedrooms are located toward the front of the home. All have easy access to a full bathroom with a dual sink vanity as well as a linen closet. For convenience, the full-sized utility room is set back from the master bedroom and provides direct access to the rear two-car garage.



OPT. MASTER RETREAT
ILO BEDROOM 2



OPT. KID'S RETREAT
ILO BEDROOM 2

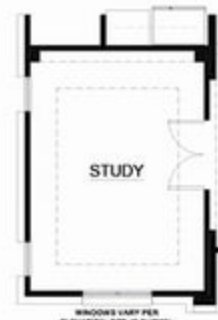

OPT. STUDY
ILO DINING

WINDOWS VARY PER
ELEVATION. OPT. IS SHOWN
WITH "X" ELEVATION

