

3633 Maize Avenue

Heartland, TX 75126

3 

2.0 

1,658 

2 



This open-concept floor plan offers warm and welcoming spaces while providing a traditional living area. With wood floors and an oversized backyard with a covered patio, this home has it all!! Designed over a single sweeping level, this open-concept floor plan offers warm and welcoming spaces while providing traditional living areas. The spacious family room features a wall of windows, that creates an inviting space for friends and family to gather. The family room provides easy access to the covered patio. Connected by a wrap-around breakfast bar is the kitchen. The kitchen features stainless steel appliances, a tile backsplash accent the granite countertop, gorgeous cabinets, and ample counter and storage space. Tucked away from the family room is the master suite, allowing parents a quiet retreat at the end of each day. Enjoy a large room with vaulted ceilings, natural light, and a large walk-in closet. The adjoined master bathroom features a dual sink vanity, large garden tub, separate walk-in shower, and linen closet. Two additional bedrooms are located toward the front of the home, making them perfect for kids or guests. Both bedrooms feature walk-in closets and have easy access to a full bathroom. For added convenience, a full-sized utility room and direct access to the two-car garage are also located at the front of the home.

CONCEPT 1638

3 Bedrooms
2 Full Baths
Family Room
Breakfast Nook
2-Car Garage
Optional Covered Patio
Optional Fireplace

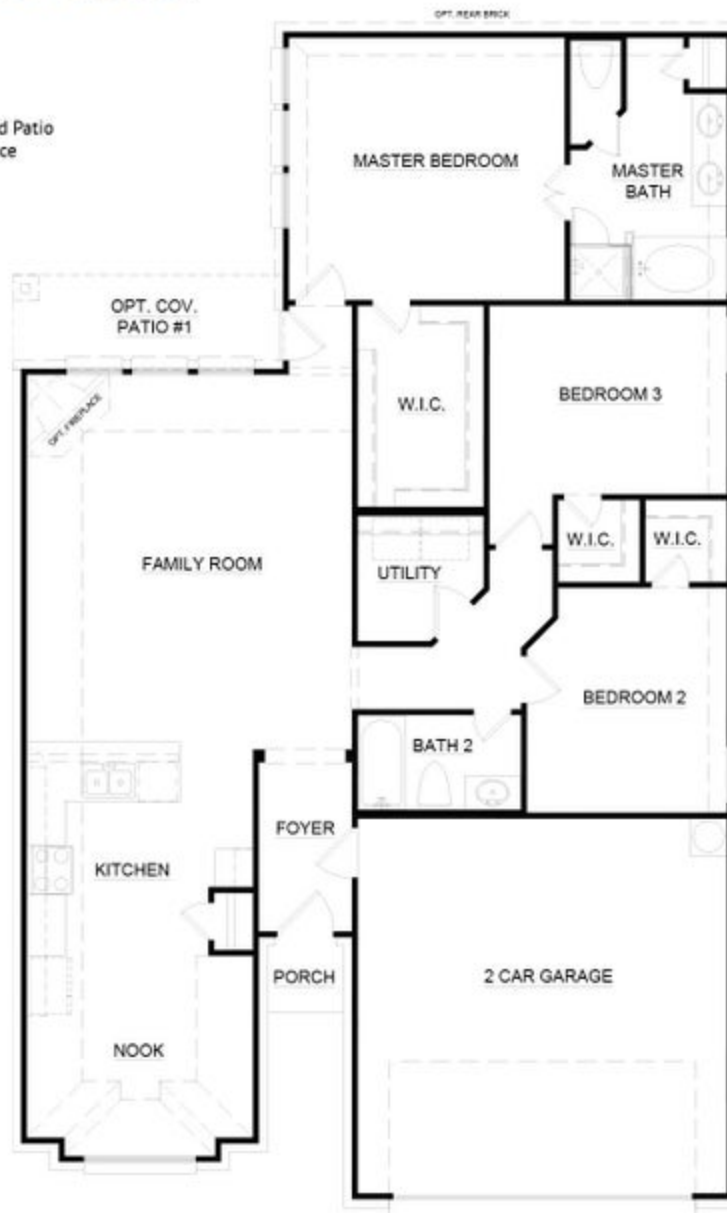

In a continuing effort to improve our products and communities, Antares Homes may (in its sole and exclusive discretion and without creating any obligation or notice) abandon, change, or otherwise modify plans, pricing, included features, home site availability, terms, etc. All images, renderings, dimensions, depictions or descriptions of home designs and layouts being offered are for representational and informational purposes only and may vary from the homes being built or completed improvements. All dimensions and designs are subject to field variations and modifications. © 2022 Antares Homes.



