

12520 Eagles Bluff

Godley, TX 76044

3 

2.0 

2,055 

2 



Feel at home from the moment you step inside. It will appeal to those who love to entertain with an open-concept design that invites you to flow seamlessly from one space to the next. A quality kitchen sits in the heart of the layout, with a walk-in pantry, granite countertops, stainless steel appliances, a center island, and it views over the breakfast nook. A large family room offers space for relaxation and, for those craving a warm and cozy feel, a stone-to-ceiling fireplace makes this a perfect place to gather with loved ones throughout winter. The luxurious owner's suite enjoys a private position, complete with a decadent master bath with twin sinks, a walk-in shower, and a soaking tub. There is also a walk-in closet, and this wing houses the utility and access to the two-car garage. The guest bedrooms are tucked away on the other side of the layout, complete with closets and easy access to the hall bath. This customizable floor plan allows you to create a space that will truly feel like home.



CONCEPT 2050

3 Bedrooms
2 Full Baths
Family Room
Dining Room
Nook
Optional Fireplace
Optional Covered Patio
Optional Study ILO Dining

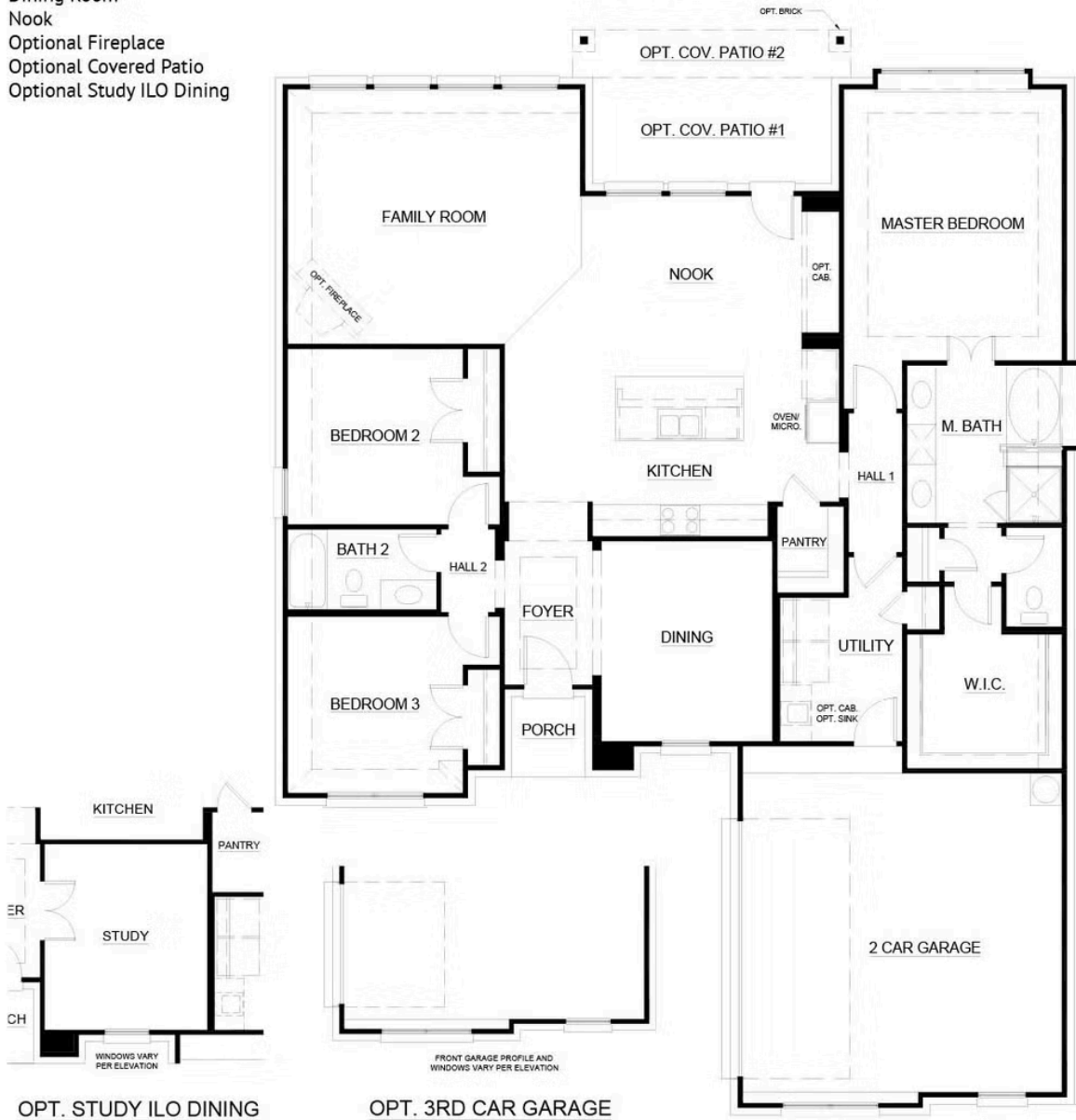

In a continuing effort to improve our products and communities, Antares Homes may (in its sole and exclusive discretion and without creating any obligation or notice) abandon, change, or otherwise modify plans, pricing, included features, home site availability, terms, etc. All images, renderings, dimensions, depictions or descriptions of home designs and layouts being offered are for representational and informational purposes only and may vary from the homes being built or completed improvements. All dimensions and designs are subject to field variations and modifications. © 2022 Antares Homes.



