

708 Misty Lane

Cleburne, TX 76033

3 

2.0 

2,065 

2 



This one-story 3-bedroom home boasts a gorgeous design that's both comfortable and stylish. The flexible floor plan allows for customization, while the formal dining room at the entrance and double-door study located near the master suite provide added convenience.

The expansive kitchen features a large center island with bar seating, quartz countertops, stainless steel appliances, white cabinets, and ample storage space. The breakfast nook is open to the kitchen and offers a built-in seat and a large window that fills the room with natural light.

The family room overlooks the backyard and provides easy access to the outdoor covered patio. It's the perfect place to relax and unwind after a long day.

The luxurious master suite features a built-in window seat with a view of the yard, a beautiful bathroom with twin sinks, a soaking tub, a walk-in shower with a seat, and a large walk-in closet.

Two additional bedrooms are in their own wing and have plenty of storage to keep everything organized, including a pair of linen closets. The full bathroom is just steps away from a designated utility room, perfect for keeping extra supplies or cleaning products in one place.

The two-car garage is located at the front of the house for convenience and privacy. Overall, this home provides the perfect combination of style and comfort, making it a wonderful place to call home.



OPT. STUDY#1 ILO DINING

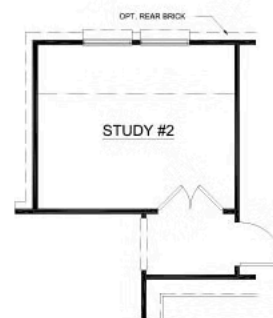

OPT. STUDY#2 ILO FLEX ROOM



OPT. 24' GARAGE

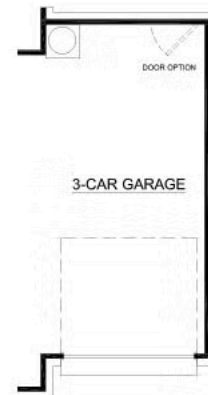

OPT. 3RD CAR GARAGE

